

STRAIGHT BITS, CARBIDE TIPPED - SINGLE FLUTE, PLUNGE CUT

BOSCH 
Power Tools

- Optimum chip clearance.
- Specially designed tip for fast plunge cutting.
- Designed for operations with high-production feed rates.

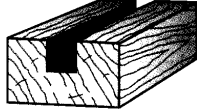
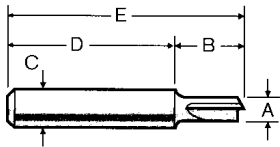

ORDER #	A	B	C	D	E	PKG.	UNIT
	CUT DIA.	FLUTE LENGTH	SHANK DIA.	SHANK LENGTH	O/A LENGTH		
85410M	1/4	1	1/4	1-3/8	2-1/2	1	EACH

STRAIGHT BITS, SOLID CARBIDE - TWO FLUTES, PLUNGE CUT

BOSCH 
Power Tools

- Positive hook angles for efficient cutting.
- Strong webbing and heavy cutter backing.
- Specially designed tip for fast plunge cutting.

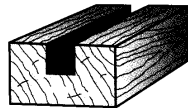
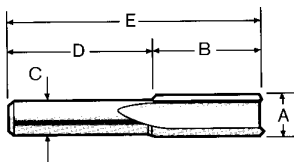

ORDER #	A	B	C	D	E	PKG.	UNIT
	CUT DIA.	FLUTE LENGTH	SHANK DIA.	SHANK LENGTH	O/A LENGTH		
85213M	1/8	3/8	1/4	1	1-9/16	1	EACH
85214M	3/16	13/32	1/4	15/16	1-5/8	1	EACH

STRAIGHT BITS, CARBIDE TIPPED - TWO FLUTES, TOP BEARING MOUNTED

BOSCH 
Power Tools

- For lettering, plunge cutting, grooving, and templet cutting.

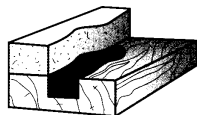
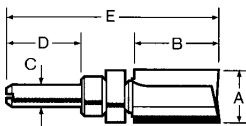

ORDER #	A	B	C	D	E	PKG.	UNIT
	CUT DIA.	FLUTE LENGTH	SHANK DIA.	SHANK LENGTH	O/A LENGTH		
85680M	1/2	1	1/4	7/8	2-1/2	1	EACH

STRAIGHT BITS, CARBIDE TIPPED - TWO FLUTES, PLUNGE CUT

BOSCH 
Power Tools

- Positive hook angles for efficient cutting.
- Strong webbing and heavy cutter backing.

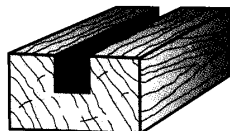
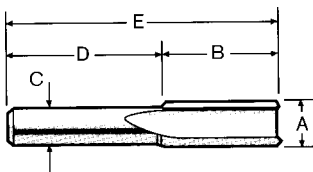

ORDER #	A	B	C	D	E	PKG.	UNIT
	CUT DIA.	FLUTE LENGTH	SHANK DIA.	SHANK LENGTH	O/A LENGTH		
85221M	1/4	5/8	1/4	1-1/16	1-11/16	1	EACH
85250M	1/4	7/8	1/4	1-1/4	2-1/8	1	EACH
85459M	1/4	7/8	1/4	1-7/8	2-7/8	1	EACH
85223M	9/32	7/8	1/4	1	1-7/8	1	EACH
85224M	5/16	1	1/4	1	2	1	EACH
85225M	3/8	1	1/4	1	2	1	EACH
85241M	3/8	1	1/2	1-9/16	2-9/16	1	EACH
85226M	7/16	1	1/4	1	2	1	EACH
85227M	1/2	1	1/4	1	2	1	EACH
85427M	1/2	1	1/2	1-1/4	2-7/16	1	EACH
85251M	1/2	2	1/2	2	4	1	EACH
85230M	5/8	5/8	1/4	1	1-5/8	1	EACH
85454M	5/8	1-1/8	1/2	1-7/16	2-11/16	1	EACH
85232	3/4	5/8	1/4	1	1-5/8	1	EACH
85265M	3/4	1-1/4	1/2	1-7/16	2-7/8	1	EACH
85243M	1	1-1/4	1/2	1-7/16	2-11/16	1	EACH

ROMAN OGEE BITS, CARBIDE TIPPED - TWO FLUTES, BALL BEARING PILOT

BOSCH

Power Tools

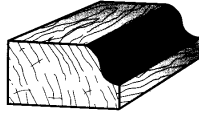
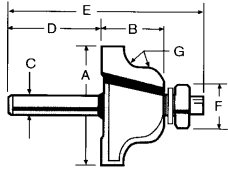

· For decorative edging and period furniture.

ORDER #	A	B	C	D	E	F	G	PKG.	UNIT
	OVERALL DIA.	FLUTE LENGTH	SHANK DIA.	SHANK LENGTH	O/A LENGTH	BORING DIA.	RADIUS		
85271M	1-1/2	3/4	1/4	1-1/4	2-3/8	1/2	1/4	1	EACH

V-GROOVING BITS, CARBIDE TIPPED - TWO FLUTES

BOSCH

Power Tools

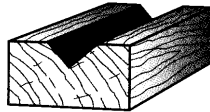
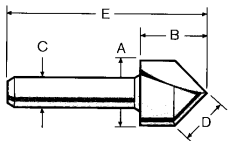

· Excellent for door front grooving, lettering, and sign work.
· Shear angle cutter geometry for smooth, efficient cutting.

ORDER #	A	B	C	D	E	PKG.	UNIT
	OVERALL DIA.	FLUTE LENGTH	SHANK DIA.	BEVEL CUT	O/A LENGTH		
85219M	1/2	5/8	1/4	3/8 (45°)	1-17/32	1	EACH

CORE BOX BITS, CARBIDE TIPPED

BOSCH

Power Tools

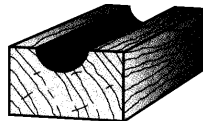
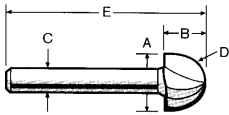

· Cuts rounded grooves used in a variety of applications ranging from doors to columns.

ORDER #	A	B	C	D	E	PKG.	UNIT
	OVERALL DIA.	FLUTE LENGTH	SHANK DIA.	RADIUS	O/A LENGTH		
85444M	1/4	3/8	1/4	1/8	2	1	EACH
85445M	3/8	5/16	1/4	3/16	1-15/16	1	EACH
85446M	1/2	3/8	1/4	1/4	2	1	EACH
85448M	3/4	1/2	1/4	3/8	2-1/8	1	EACH

45° CHAMFER BITS, CARBIDE TIPPED - TWO FLUTES, BALL BEARING PILOT

BOSCH

Power Tools

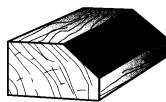
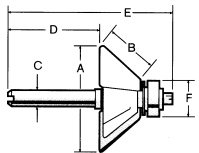

· For beveling and decorative edging.

ORDER #	A	B	C	D	E	F	PKG.	UNIT
	OVERALL DIA.	FLUTE LENGTH	SHANK DIA.	SHANK LENGTH	O/A LENGTH	BORING DIA.		
85298M	1-1/2	11/16	1/4	1-1/4	2-3/16	1/2	1	EACH
85597M	1-1/2	11/16	1/2	1-1/4	2-7/16	1/2	1	EACH

**New items are always being added.
Please call us if you need an item not listed.**

ROUND OVER BITS, CARBIDE TIPPED - TWO FLUTES, BALL BEARING PILOT

BOSCH 
Power Tools

- For smooth, uniformly rounded edges.
- Lower depth setting produces rounded corner with decorative bead.

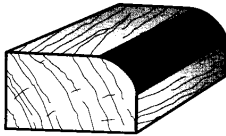
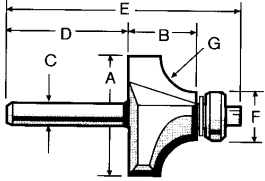

ORDER #	A	B	C	D	E	F	G	PKG.	UNIT
	OVERALL DIA.	FLUTE LENGTH	SHANK DIA.	SHANK LENGTH	O/A LENGTH	BORING DIA.	CUTTING RADIUS		
85290M	3/4	5/16	1/4	1-1/4	1-15/16	1/2	1/8	1	EACH
85293M	7/8	31/64	1/4	1-1/4	2-1/8	1/2	3/16	1	EACH
85294M	1	35/64	1/4	1-1/4	2-3/16	1/2	1/4	1	EACH
85295M	1-1/8	37/64	1/4	1-1/4	2-3/16	1/2	5/16	1	EACH
85296M	1-1/4	43/64	1/4	1-1/4	2-3/8	1/2	3/8	1	EACH
85594M	1-1/4	43/64	1/2	1-1/2	2-5/8	1/2	3/8	1	EACH
85297M	1-1/2	51/64	1/4	1-1/4	2-7/16	1/2	1/2	1	EACH
85434M	2	1	1/2	1-1/2	3	1/2	3/4	1	EACH

BEADING BITS, CARBIDE TIPPED - TWO FLUTES, BALL BEARING PILOT

BOSCH 

- Used wherever attractive, decorative edging is needed.

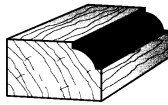
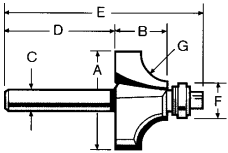

ORDER #	A	B	C	D	E	F	G	PKG.	UNIT
	OVERALL DIA.	FLUTE LENGTH	SHANK DIA.	SHANK LENGTH	O/A LENGTH	BORING DIA.	CUTTING RADIUS		
85495M	1-1/8	37/64	1/4	1-1/4	2-5/32	3/8	5/16	1	EACH

EDGE BEADING BITS, CARBIDE TIPPED - BALL BEARING PILOT

BOSCH 
Power Tools

- Versatile bit adds attractive edging on new pieces and matches many older molding cuts for remodeling work.

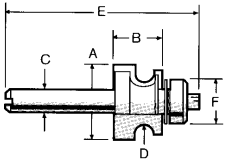

ORDER #	A	B	C	D	E	F	PKG.	UNIT
	OVERALL DIA.	FLUTE LENGTH	SHANK DIA.	CUTTING RADIUS	O/A LENGT	BEARING DIA.		
85631M	7/8	17/32	1/4	1/8	2-5/32	1/2	1	EACH

COVE & BEAD BITS, CARBIDE TIPPED - BALL BEARING PILOT

BOSCH 
Power Tools

- A classic woodworking design.
- An attractive accent to any piece.

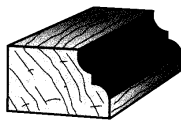
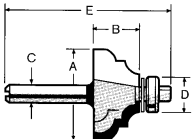

ORDER #	A	B	C	D	E	PKG.	UNIT
	OVERALL DIA.	FLUTE LENGTH	SHANK DIA.	BORING DIA.	O/A LENGTH		
85604M	1-5/16	5/8	1/4	1/2	2-1/4	1	EACH
85605M	1-5/16	5/8	1/2	1/2	2-1/2	1	EACH

SHS - One complete source for all of your finish hardware needs.

COVE BITS, CARBIDE TIPPED - TWO FLUTES, BALL BEARING PILOT

BOSCH 
Power Tools

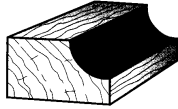
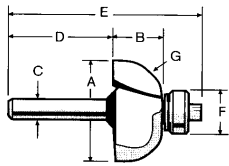

· For decorative edging and period furniture.

ORDER #	A	B	C	D	E	F	G	PKG.	UNIT
	OVERALL DIA.	FLUTE LENGTH	SHANK DIA.	SHANK LENGTH	O/A LENGTH	BORING DIA.	CUTTING RADIUS		
85205M	1	1/2	1/4	1-1/4	2-1/8	1/2	1/4	1	EACH
85206M	1-1/4	9/16	1/4	1-1/4	2-13/6	1/2	3/8	1	EACH
85207M	1-1/2	5/8	1/4	1-1/4	2-1/4	1/2	1/2	1	EACH

CLASSICAL BITS, CARBIDE TIPPED - BALL BEARING PILOT

BOSCH 
Power Tools

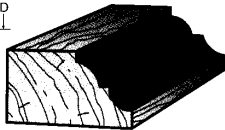
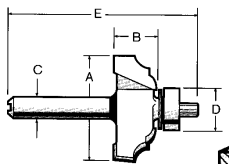

· Adds classic beauty to your product with decorative edging.

ORDER #	A	B	C	D	E	PKG.	UNIT
	OVERALL DIA.	FLUTE LENGTH	SHANK DIA.	BORING DIA.	O/A LENGTH		
85579M	1-1/4	1/2	1/4	1/2	2-1/4	1	EACH

RABBETING BITS, CARBIDE TIPPED - TWO FLUTES, BALL BEARING PILOT

BOSCH 
Power Tools

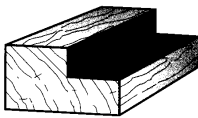
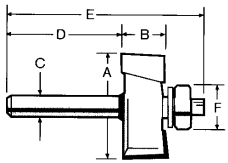

· For fast, smooth, rabbeting cuts without use of router guide.

ORDER #	RABBET WIDTH	A	B	C	D	E	F	PKG.	UNIT
		OVERALL DIA.	CUTTER LENGTH	SHANK DIA.	SHANK LENGTH	O/A LENGTH	BORING DIA.		
85218M	3/8	1-1/4	1/2	1/4	1-1/4	2-1/8	1/2	1	EACH

BEVEL TRIMMER BIT, SOLID CARBIDE

BOSCH 
Power Tools

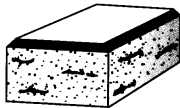
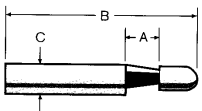

· Provides 7-1/2° bevel on trim edge of plastic, laminate surfaces.
· Self-pilot eliminates guide assembly.

ORDER #	A	B	C	TYPE CUT	PKG.	UNIT
	FLUTE LENGTH	O/A LENGTH	SHANK DIA.			
85286M	1/4	1-1/2	1/4	7.5° BEVEL	1	EACH

STAGGERTOOTH PILOT PANEL BIT W/DRILL-THROUGH POINT, CARBIDE TIPPED

BOSCH 
Power Tools

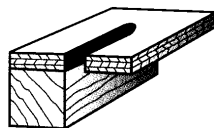
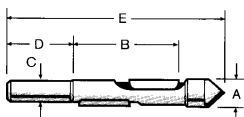

· Staggered flutes give excellent chip clearance and high feed rates.
· Used for production cutting of windows, doors and other openings in abrasive materials.

ORDER #	A	B	C	D	E	PKG.	UNIT
	CUT DIA.	FLUTE LENGTH	SHANK DIA.	SHANK LENGTH	O/A LENGTH		
85408M	5/8	2-1/4	1/2	1-7/16	4-3/4	1	EACH

2-FLUTE LAMINATE FLUSH TRIMMING BITS, CARBIDE TIPPED - BALL BEARING PILOT

BOSCH 

Power Tools

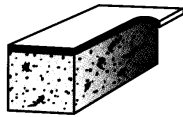
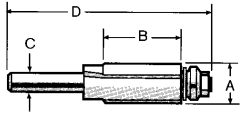

- For fast, smooth, accurate trim cuts.
- Shielded, compact ball bearing pilot.

ORDER #	A	B	C	D	PKG.	UNIT
	CUT DIA.	FLUTE LENGTH	SHANK DIA.	O/A LENGTH		
85268M	3/8	1	1/4	2-9/16	1	EACH
85269M	3/8	1/2	1/4	2-1/4	1	EACH
85266M	1/2	1	1/4	2-3/8	1	EACH
85267M	1/2	5/8	1/4	2-5/32	1	EACH

2-FLUTE TEMPLET/TRIMMING BIT, CARBIDE TIPPED - BALL BEARING PILOT

BOSCH 

Power Tools

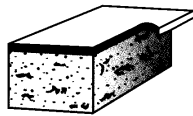
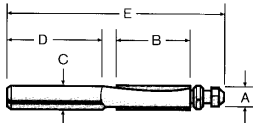

- Smooth cuts; for laminate trimming, cutouts, and pattern cutting.
- Can be used with two ball bearings to widen bearing surface and reduce templet wear.
- Extra ball bearing part#: 2 610 906 500.

ORDER #	A	B	C	D	E	PKG.	UNIT
	CUT DIA.	FLUTE LENGTH	SHANK DIA.	SHANK LENGTH	O/A LENGTH		
85601M	1/2	1-1/2	1/2	1-7/8	4-7/16	1	EACH

3-FLUTE TRIMMING BIT, CARBIDE TIPPED - BALL BEARING PILOT

BOSCH 

Power Tools

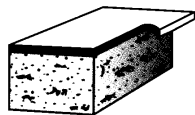
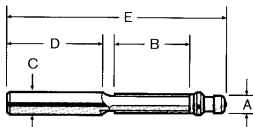

- Extra smooth cuts; for laminate trimming and trim cuts on heavier work when cutting using a templet.
- Can be used with two ball bearings to widen bearing surface and reduce templet wear.
- Extra ball bearing part#: 2 610 906 500.

ORDER #	A	B	C	D	E	PKG.	UNIT
	CUT DIA.	FLUTE LENGTH	SHANK DIA.	SHANK LENGTH	O/A LENGTH		
85602M	1/2	1-1/2	1/2	1-5/8	4-7/16	1	EACH

3-FLUTE LAMINATE FLUSH TRIMMING BIT, CARBIDE TIPPED - BALL BEARING PILOT

BOSCH 

Power Tools

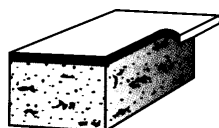
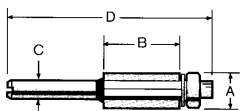

- Gives chatter-free production trimming with extra smooth, flush trim cut.
- Compact ball bearing assembly is equipped with glue shield.
- Replacement bearing part#: 2 610 906 500.

ORDER #	A	B	C	D	PKG.	UNIT
	CUT DIA.	FLUTE LENGTH	SHANK DIA.	SHANK LENGTH		
85216M	1/2	1	1/4	2-9/16	1	EACH

2-FLUTE ECONOMY LAMINATE TRIMMER ASSEMBLIES, CARBIDE TIPPED - BALL BEARING PILOT

BOSCH 
Power Tools

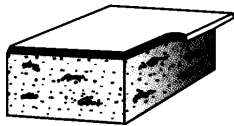
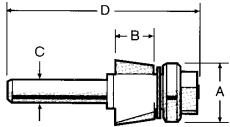

- For fast, accurate trim cuts.
- Economy priced replaceable cutter and bearing.
- Shank replacement arbor part#: 82808.

ORDER #	A	B	C	D	TYPE CUT	PKG.	UNIT
	BEARING DIA.	FLUTE LENGTH	SHANK DIA.	OVERALL LENGTH			
85431M	5/8	3/8	1/4	1-15/16	10°BEVEL	1	EACH

FLUSH & BEVEL 3-FLUTE LAMINATE TRIMMER ASSEMBLIES - CARBIDE TIPPED, BALL BEARING PILOT

BOSCH 
Power Tools

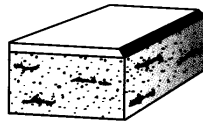
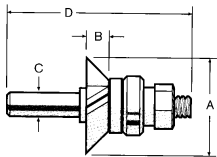

- For extra smooth production trimming.
- Assembly includes arbor, replaceable 3-wing cutter, and ball bearing.
- A favorite bit in high-production shops for years.

ORDER #	A	B	C	D	TYPE CUT	PKG.	UNIT
	OVERALL DIA.	FLUTE LENGTH	SHANK DIA.	O/A LENGTH			
85421M	5/8	3/8	1/4	1-15/16	FLUSH	1	EACH
85420M	7/8	3/8	1/4	1-15/16	22°BEVEL	1	EACH
85423M	1	1/4	1/4	1-15/16	45°BEVEL	1	EACH

4-FLUTE LAMINATE TRIMMER ASSEMBLIES, CARBIDE TIPPED - BALL BEARING PILOT

BOSCH 
Power Tools

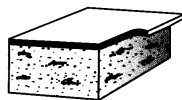
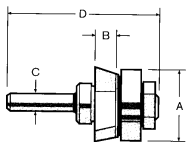

- For ultra-smooth finish trimming.
- Ball bearing is equipped with glue shield.
- Components are individually replaceable.

ORDER #	A	B	C	D	TYPE CUT	PKG.	UNIT
	BEARING DIA.	FLUTE LENGTH	SHANK DIA.	OVERALL LENGTH			
85415M	7/8	3/8	1/4	2-1/4	15°BEVEL	1	EACH

FLUSH TRIMMER BIT, SOLID CARBIDE

BOSCH 
Power Tools

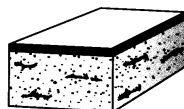
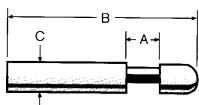

- Makes a flush, trim, edge cut.
- Self-pilot.

ORDER #	A	B	C	TYPE CUT	PKG.	UNIT
	FLUTE LENGTH	O/A LENGTH	SHANK DIA.			
85285M	1/4	1-1/2	1/4	FLUSH	1	EACH

2-WING SLOTTING CUTTERS, CARBIDE TIPPED

BOSCH 

Power Tools

· Used to make slots for T-molding & weather-stripping.

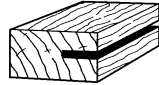
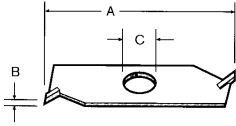

ORDER #	A	B	C	DEPTH OF CUT	PKG.	UNIT
	CUTTER DIA.	KERF	ARBOR DIA.			
85505M	1-3/16	1/4	1/4	9/32	1	EACH
85517M	1-7/8	1/16	5/16	1/2	1	EACH

ARBOR SELECTION FOR 2-WING SLOTTING CUTTERS

BOSCH 

Power Tools

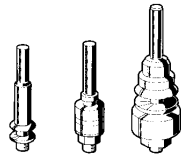

82805 82808 82810

ORDER #	SHANK DIA.	ARBOR DIA.	LENGTH	BALL BEARING DIA.	CUTTER #S	PKG.	UNIT
82805	1/4	1/4	2	-	85505, 85506, 85507, 85508	1	EACH
82808	1/4	1/4	1-29/32	5/8	85505, 85506, 85507, 85508	1	EACH
82810	1/4	5/16	2-5/8	7/8	85517, 85520	1	EACH

3-WING SLOTTING CUTTERS, CARBIDE TIPPED

BOSCH 

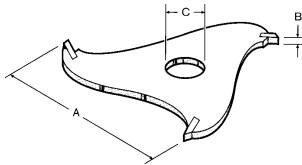

· Used to make slots for T-molding & weather stripping.
· Three wings for extra strength and long life.

ORDER #	A	B	C	DEPTH OF CUT	PKG.	UNIT
	CUTTER DIA.	KERF	ARBOR DIA.			
85526M	1-7/8	1/16	5/16	1/2	1	1
85527M	1-7/8	5/64	5/16	1/2	1	EACH
85528M	1-7/8	3/32	5/16	1/2	1	EACH
85529M	1-7/8	1/8	5/16	1/2	1	EACH
85610M	1-7/8	1/4	5/16	1/2	1	EACH

ARBOR SELECTION FOR 3-WING CUTTERS

BOSCH 

Power Tools



82811

ORDER #	SHANK DIA.	ARBOR DIA.	LENGTH	BALL BEARING DIA.	USED ON PART#S	PKG.	UNIT
82811	1/2	5/16	3	7/8	85520M, 85609M, 85610M	1	EACH
92813	1/4	5/16	1-23/32	-	85526M, 85527M, 85528M, 85529M, 92837	1	EACH

**New items are always being added.
Please call us if you need an item not listed.**

KEY HOLE BIT, CARBIDE TIPPED - PLUNGE & SLOT CUTS

BOSCH 
Power Tools

- Routes mounting slots in picture frames, plaques.
- M - indicates super sharp bit.

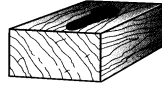
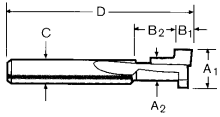

ORDER #	CUT TYPE	A	B	C	D	PKG.	UNIT
		CUT DIA.	FLUTE LENGTH	SHANK DIA.	O/A LENGTH		
85608M	PLUNGE 1	A1 - 3/8	B1 - 3/16	1/4	1-7/8	1	EACH
	SLOT2	A2 - 3/16	B2- 11/32	-	-		

HINGE MORTISING BIT, CARBIDE TIPPED

BOSCH 
Power Tools

- Fast-cutting bit for making mortises when work is started at the edge.
- Smooth finish makes this bit ideal for surfacing operations.
- Also used where good chip clearance is important in material such as gummy wood.

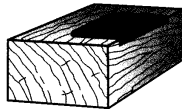
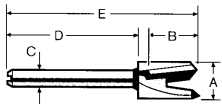

ORDER #	A	B	C	D	E	PKG.	UNIT
	OVERALL DIA.	FLUTE LENGTH	SHANK DIA.	SHANK LENGTH	O/A LENGTH		
85249M	1/2	1/2	1/4	1-1/2	2-3/32	1	EACH

HINGE MORTISING BIT, CARBIDE TIPPED

BOSCH 
Power Tools

- Fast-cutting bit for making mortises when work is started at the edge.
- Smooth finish cut makes this bit ideal for surfacing operations.
- Also used where good chip clearance is important in materials such as gummy wood.
- Cuts mortise for hinge butts with 5/8" corner radius.
- Will cut entire mortise in one pass.
- Shank sold separately.

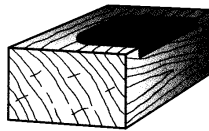
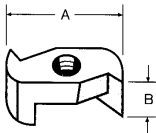

ORDER #	A	B	THREAD	PKG.	UNIT
	OVERALL DIA.	FLUTE LENGTH			
85238M	1-1/4	17/32	5/16-24	1	EACH

DOOR CUTTER BIT, CARBIDE TIPPED - FOR AMEROCK® DEMOUNTABLE HINGES

Amerock



ORDER #	SHANK	PKG.	UNIT
WM5R	3/8"	1	EACH

Our inside and outside sales staff is available to assist you with whatever your needs may be.

DELUXE DOOR & JAMB HINGE TEMPLATE KIT

BOSCH 
Power Tools



- For metal or wood stops.
- Transfers directly from jamb to door (or vice-versa) with hinges on either side of door. No turning templet end over end.
- Works with or without changing hinge size or door thickness adjustments.
- Kit Includes: Deluxe Hinge Template, 3-605-438-520 metal case, one regular & one 3-601-321-516 extra long top gauge assembly, 82864 templet guide, & 85159 bit.

ORDER #	PKG.	UNIT
83038	1	EACH

DELUXE BORING JIG KIT



- Boring Jig Kit complete with basic fixture for standard 2-3/8" and 2-3/4" backset positioning. 2-1/8" spur bit, 1-1/2" spur bit, 1" spur bit, 3/8" hex drive quick release adapter, 1-1/2" reducer ring, latch templates for 1" x 2-1/4" and 1-1/8" x 2-1/4", strike templates for 1" x 2-1/4" and 1-1/8" x 2-3/4" "T" and deadbolt, strike center marker with hardened steel point, spring loaded corner chisel, carrying case.

ORDER #	PKG.	UNIT
BJ-115	1	EACH

LATCH & STRIKE TEMPLATES

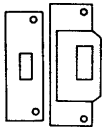

- **Kit Includes:** Latch template, strike template, center locator.
- Latch size: 1" x 2-1/4".
- Strike size: 1" x 2-1/4".

ORDER #	PKG.	UNIT
LS-166A	1	EACH

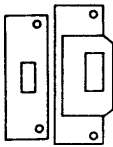

- **Kit Includes:** Latch template, strike template, center locator.
- Latch size: 1-1/8" x 2-1/4".
- Strike size: 1-1/8" x 2-3/4".

ORDER #	PKG.	UNIT
LS-171B	1	EACH

CORNER CHISEL

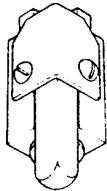

ORDER #	PKG.	UNIT
CC1	1	EACH

LATCH MARKING CHISELS

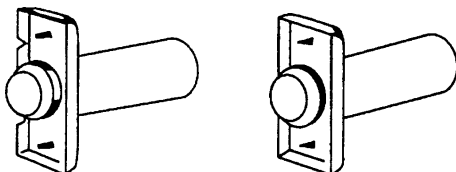

SCHLAGE

- Spring loaded.
- Mortise 1/4" Radius to Square.

ORDER #	SIZE	PKG.	UNIT
40-031	1" x 2-1/4"	1	EACH
40-032	1-1/8" x 2-1/4"	1	EACH

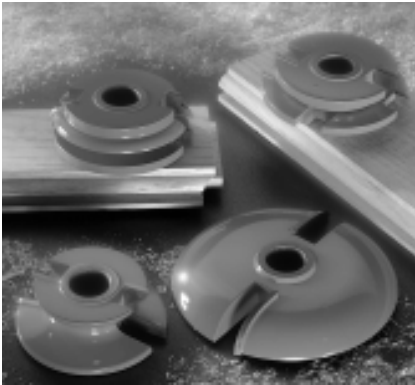

Freeborn Tool Company features a complete collection of high quality Carbide and T-Alloy tipped shaper cutters. Freeborn cutters have a unique distinction as American made tooling with superior geometry. Specializing in cutting tools has made Freeborn a leader among tooling manufacturers.



Spokane Hardware Supply, Inc. is an authorized dealer of Freeborn Tool Company.

Call us today for a catalog or more information

MATERIALS

T-Alloy Tipped

- Freeborn offers a complete line of shaper cutters with T-Alloy tips, uniquely designed for cutting natural woods (not to be used for man-made materials). T-Alloy is one of the most advanced cutting materials on the market today. It is extremely durable to better resist chipping and cracking, as well as corrosion from wood acids. They can also be face-honed between sharpenings for extra long life. (T-Alloy cutters are painted bright yellow).

Carbide Tipped

- Carbide tipped cutters are still unsurpassed while working with man-made materials such as particle board, plywood and fiberboard. The time-test, orange colored Freeborn cutters offer a geometrically precise design that provides long life and unmatched results in a variety of applications.



SERIES

- Choose from Mini-Pro, Pro-Line or Signature Series Cutters, or have Freeborn design a custom cutter to fit your specific requirements.
- Mini-Pro Series:** 3-Wing cutters with a 3/4" bore.
- Pro-Line Series:** 3-Wing cutters with a 1-1/4" bore.
- Signature Series:** 2-Wing cutters with a 3/4" bore (only available in carbide)
- Custom:** If you don't find what you need please call Freeborn, custom products available.

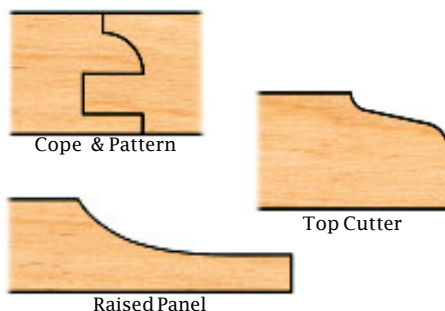

FREEBORN STOCK PROFILES INCLUDE:

- Cope & Pattern
- Double Sided Cope & Pattern
- Flat Panel Cope & Pattern
- Center Groover Sets
- Raised Panel Shaper Cutters
- Door Edge Detail Shaper Cutters
- Door Edge Detail Bevel Cutters
- Reversible Glue Joint
- V-Paneling Shaper Cutter Set
- Flooring Sets
- Quarter Round Convex Cutters
- Straight Top Groovers
- Half Round Shaper Cutters
- Corner Rounding Shaper Cutters
- Extended Corner Rounds
- Reversible Pattern Detail
- Window Sash Cutter Set
- Tongue & Groove Lock Mitre Cutter
- Drawer Lock Cutter
- Matched Drop Leaf
- Double Easing Cutters
- Accessories (bearings, etc.)